

1. Raumpläne Rooms

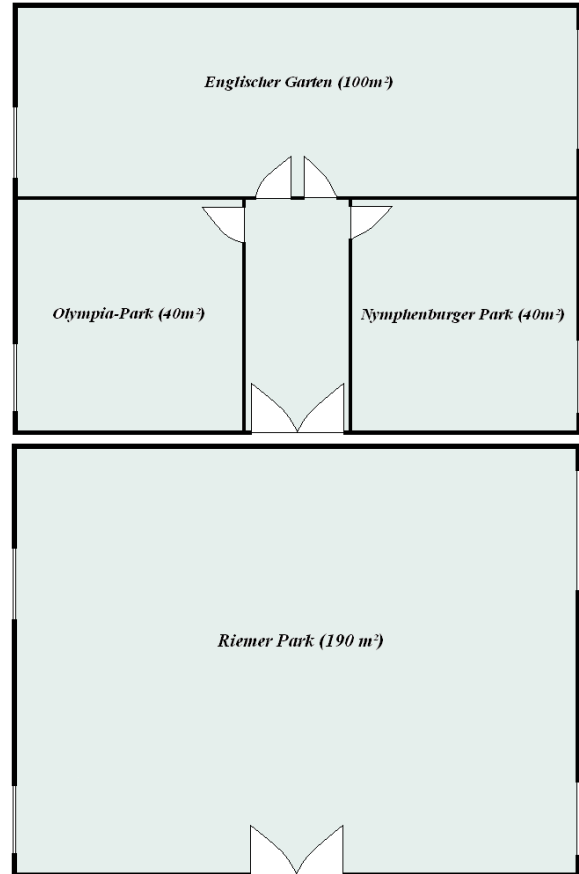
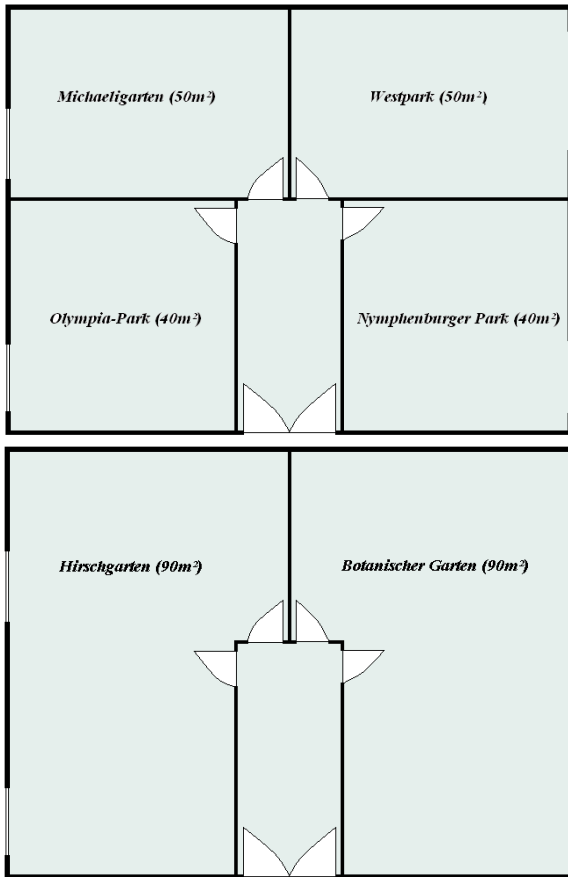

Tagungsraum Conference room	m ² m ²	L x B x H L x W x H	Etage Floor										@/€	WiFi/€
Luitpoltpark a	25	5x5x2,5	0G/+1	12	12	10	-	10	✓	✓	✓	-	-	✓ / -
Nymphenburger Park b	40	6,3x6,3x2,6	UG/-1	10	15	10	10	10	✓	✓	-	-	✓ / -	✓ / -
Olympiapark e	40	6,3x6,3x2,6	UG/-1	10	15	10	10	10	-	✓	-	-	✓ / -	✓ / -
Westpark c	50	7x7,1x2,6	UG/-1	20	20	15	15	15	✓	✓	-	-	✓ / -	✓ / -
Michaeligarten d	50	7x7,1x2,6	UG/-1	20	20	15	15	15	-	✓	-	-	✓ / -	✓ / -
Hirschgarten (e+d)	90	13,3x7,1x2,6	UG/-1	30	35	25	25	25	-	✓	-	-	✓ / -	✓ / -
Botanischer Garten (b+c)	90	13,3x7,1x2,6	UG/-1	30	35	25	25	25	✓	✓	-	-	✓ / -	✓ / -
Englischer Garten (c+d)	100	15,8x6,4x2,6	UG/-1	40	40	25	20	25	✓	✓	-	-	✓ / -	✓ / -
Riemer Park (a+b+c+d+e)	190	12x15,8x2,6	UG/-1	120	120	70	50	60	✓	✓	-	-	✓ / -	✓ / -

Zeichenerklärung / Legend:

Stehempfang/Reception

Stuhlreihen/Theatre

Parlamentarisch/Parliamentary

U-Form/U-shape

Block/Block

Tageslicht/Daylight

Verdunkelbar/Windows can be shaded

Klimaanlage/Air conditioning

Behindertengerecht/Handicapped accessible

@ Internet/Internet

W-LAN/WiFi

€ Kostenpflichtig/With costs