

# The perfect room for any occasion.

Every event is unique, so we offer a multitude of facilities – from our grand 3,000-square foot waterfront ballroom to numerous smaller meeting and event spaces. Our personalized service means that we'll work with guests to ensure that all the details – food and beverage, audio-visual equipment and more – are taken care of to their specifications.

The numerous quality amenities available at the Hotel Grand Pacific also provide added value to any event. We offer multiple dining options, for rehearsal dinners or receptions; our Spa for wedding party prepping or a great spousal or après-meeting activity including complimentary access to the Victoria Athletic Club which features everything from a 25-metre lap pool to yoga and fitness classes.

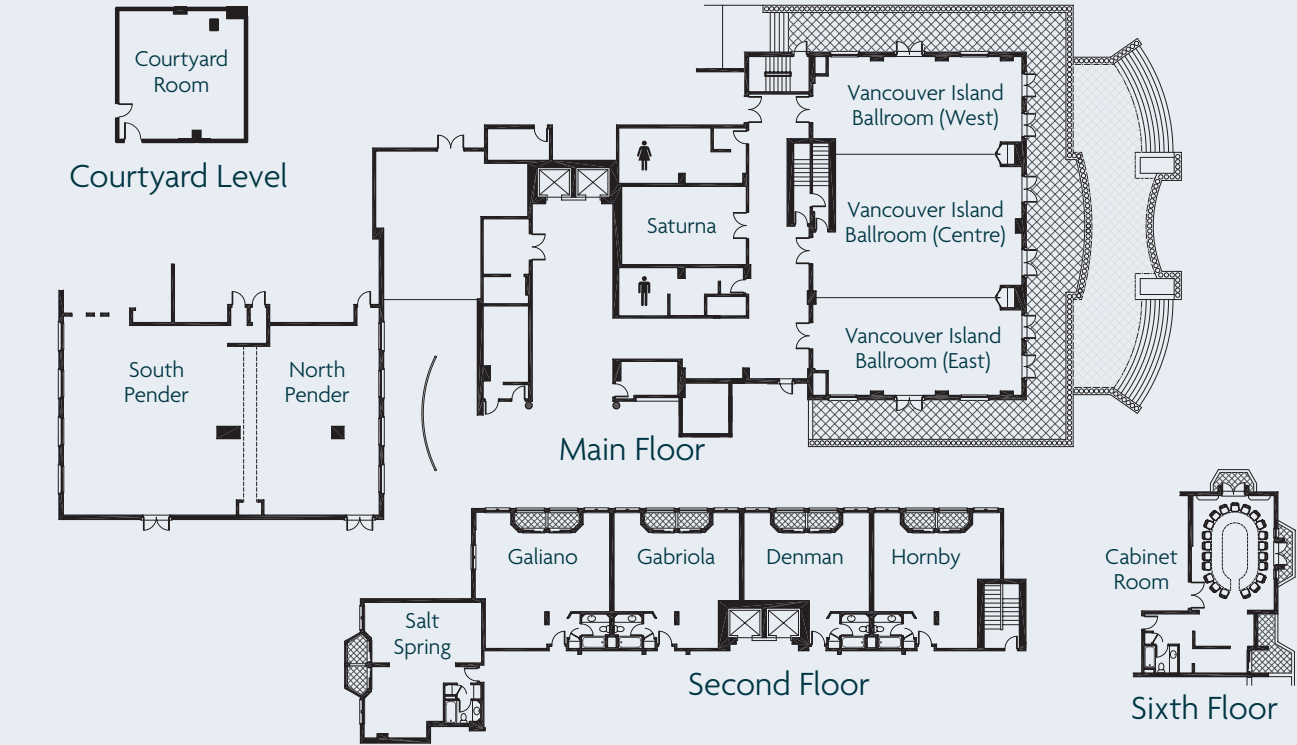



MEETING ROOMS	DIMENSIONS	SQ FT	CLASSROOM	THEATRE	ROUND TABLES	U-SHAPE	HOLLOW-SQUARE	BOARDROOM	RECEPTION
NO AUDIO VISUAL									
Vancouver Island Ballroom	70' x 43' x 11'	3010	200 / 170	250	23 / 20	78	98	N/A	300
- East	20' x 43'	860	50 / 40	60	5 / 4	27	30	27	60
- Centre	30' x 38' / 30'x43'	1290	70 / 60	110	8 / 7	32	40	32	120
- West	20' x 40'	800	50 / 40	60	5 / 4	27	30	27	60
- Centre/east		2150	130 / 100	160	13 / 11	56	70	56	200
- Centre/west		2090	130 / 100	160	13 / 11	54	70	54	200
Saturna	16' x 27' x 8'	432	24	35/30	2 / 2	18	22	18/16	30
Pender Island Ballroom	38 ' x 62' x 11'	2437	100 / 90	180	13 / 10	N/A	N/A	N/A	200
- South	38' x 37'	1425	60	100	7 / 6	34	40	28/26	120
- North	38' x 25'	1012	35	60	5/4	24	26	26/24	60
** With Rear Screen									
Saltspring Room 231	28' x 15' / 28' x 23'	644	26	30	3 / 3	N/A	N/A	20 / 16	35
Galliano Room 233	29' x 16' / 29' x 23'	667	30	40	3 / 3	24	26	26 / 24	40
Gabriola Room 237	27' x 16' / 27' x 13'	432	24	35	2 / 2	20	22	18 / 16	35
Denman Room 241	27' x 13'	351	20	25	2 / 2	--- Suggest Boardroom ---		18 / 16	30
Hornby Room 245	22' x 17' / 27' x 17	459	20	30	2 / 2	16	18	16 / 14	30
Cabinet Room 612	19' x 34'	640	N/A	N/A	na	18	n/a	n/a	N/A
Courtyard Room	21'x26'	546	22	N/A	na	16	20	14/12	N/A

Note: first capacity is full room capacity / second capacity is maximum capacity with standard audio visual (screen/projector/podium)