



THE BELFRY

HOTEL & RESORT



The Ultimate Venue

WELCOME TO THE BELFRY

Effortless Corporate Entertaining

Some might say corporate events organisation at The Belfry runs as smoothly as our world-famous greens; certainly we lavish the same attention to detail on it. Our professional team are dedicated to providing a personal, attentive service which begins the moment you first make contact and continues until your last guest leaves.

The Address To Impress

Extensive facilities and the highest standards of service are delivered against a backdrop of 550 acres of rolling North Warwickshire countryside: the perfect setting for a successful and memorable event.

With 319 Signature bedrooms, 14 luxury suites, more than 20 conference and event suites accommodating up to 400 guests, 6 boardrooms, all with the latest technology, 3 iconic golf courses, a luxurious spa and leisure club, a variety of bars and restaurants, onsite nightclub, spectacular outdoor space and free car parking, our facilities cannot fail to impress.

Our meeting and event rooms have natural daylight, cutting edge technology, wi-fi, air conditioning and most have an outdoor space.



*Become part
of the legend*

*Experience our
world class luxury*

*iconic greens and
elegant bedrooms*

WHERE YOUR WORK TAKES THE STAGE

Experience Counts

Whether you're organising a discreet off-site board meeting, a full scale conference or a pivotal product launch, the Events team at The Belfry is ready to listen to your requirements, recommend the best solution and deliver exceptional levels of service to ensure your event is a success.



A Meeting Of Minds

The Belfry's comprehensive suite of 22 conference and event rooms means that whatever your meeting requirements, we have the perfect venue to match. From theatre-style to boardroom, formal reception themed cabaret to exhibitions in our stand alone Woodlands Suite, we have the imagination and expertise to give your vision life.

Looking For Something Unique?

If you'd like something a little different to the traditional event space, you could have exclusive use of our nightclub which is perfect for after show parties, product launches, catwalk shows or private corporate parties. This diverse space, with state of the art music and lighting systems, can be completely transformed in the day.

Room Maximum Capacities

THE WOODLAND SUITE	400
THE WARWICK SUITE	300
THE WISHAW SUITE	207
THE LICHFIELD SUITE	160
THE SUTTON SUITE	120
THE WORCESTER SUITE	72
THE STAFFORD SUITE	60
THE RYDER ROOM	50
THE COTTON SUITE	48
THE KINGSBURY SUITE	30
BOARDROOMS	12
BEL AIR NIGHTCLUB AND LOUNGE	1,000
TOUCHDOWNS	6
THE WINE ROOM PRIVATE DINING	12
LAKE VIEW	40

*Exclusive
use*





WORK, REST AND PLAY

The Great Outdoors

A Segway safari, an 'It's a Knockout' assault course, laser shooting, tennis courts, putting competitions, al fresco dining - almost anything is possible. From the wild to the wonderful, the exciting to the exclusive, we'll create exactly the day you imagine.

No Stone Unturned

For an experience to remember; let us devise an event that truly stands out from the crowd. From corporate golf days to champagne receptions, themed awards ceremonies to activities and team building, we've got hundreds of ideas and all the necessary facilities at our disposal. We can also organise prize tables, branded merchandise and clothing for your events.



Workout Or Relax And Unwind

Work out, stretch out or just chill out in the Belfry Leisure Club. You could take a dip in the indoor pool, join us for an exercise class, or shape up in the state-of-the-art gym. If all that sounds too much like hard work, invigorate your senses in the Fire & Ice Sensarium. Explore 12 bio thermal rooms including a foot spa, feature showers, aroma cave, sauna, igloo, crystal steam and tranquility room.

Our luxury spa is the perfect retreat. With luxurious treatment rooms and the elegant relaxation room with sumptuous day beds; everything has been carefully designed to spoil you from head to toe. From the moment you arrive, you can leave the world behind as we take you on a journey of pure delight.



LEGENDARY GOLF

The Belfry has 3 golf courses. The famous and iconic Brabazon, 4 time host to the Ryder Cup and legendary in the world of golf, the PGA National, the only PGA branded course in England and The Derby, perfect for players of all levels. The PGA National Golf Academy reflects The Belfry's dedication to golf, offering world-class tuition, 34 bay driving range and custom fitting experience. So whether you're an advanced golfer, or wanting to learn the basics, the PGA National Golf Academy at The Belfry caters for all golfers of all abilities.

Browse and test out the latest cutting-edge golf equipment from leading manufacturers at one of Europe's largest on-course golf shops. Raise your game with the latest kit from some of the sport's biggest brands including TaylorMade, Callaway, Ping, Titleist and Nike. We also stock a full range of men and women's wear plus our own range of high-quality Belfry branded items.

*Spiritual home of
the Ryder Cup*



PASSIONATE ABOUT FOOD

Every day, The Belfry's team of talented chefs relish in creating imaginative, high quality food

Featuring locally sourced ingredients – some grown in our grounds – our dishes demonstrate how passionate we are about creating the perfect dining experience. Tasty boardroom lunches, lavish black-tie banquets or private dining options in any room, our range of menus will always impress.

With our options for dining, you'll have plenty of choice

THE RYDER GRILL guests can enjoy stunning views of the golf course whilst watching the theatre of the open plan kitchen.

SAM'S CLUB HOUSE offers a more casual dining experience and broadcasts the latest live worldwide sport.

THE BRABAZON BAR serves a range of cocktails, fine wines, afternoon teas and light bites.

GRAB AND GO with a range of food and drinks from Starbucks.

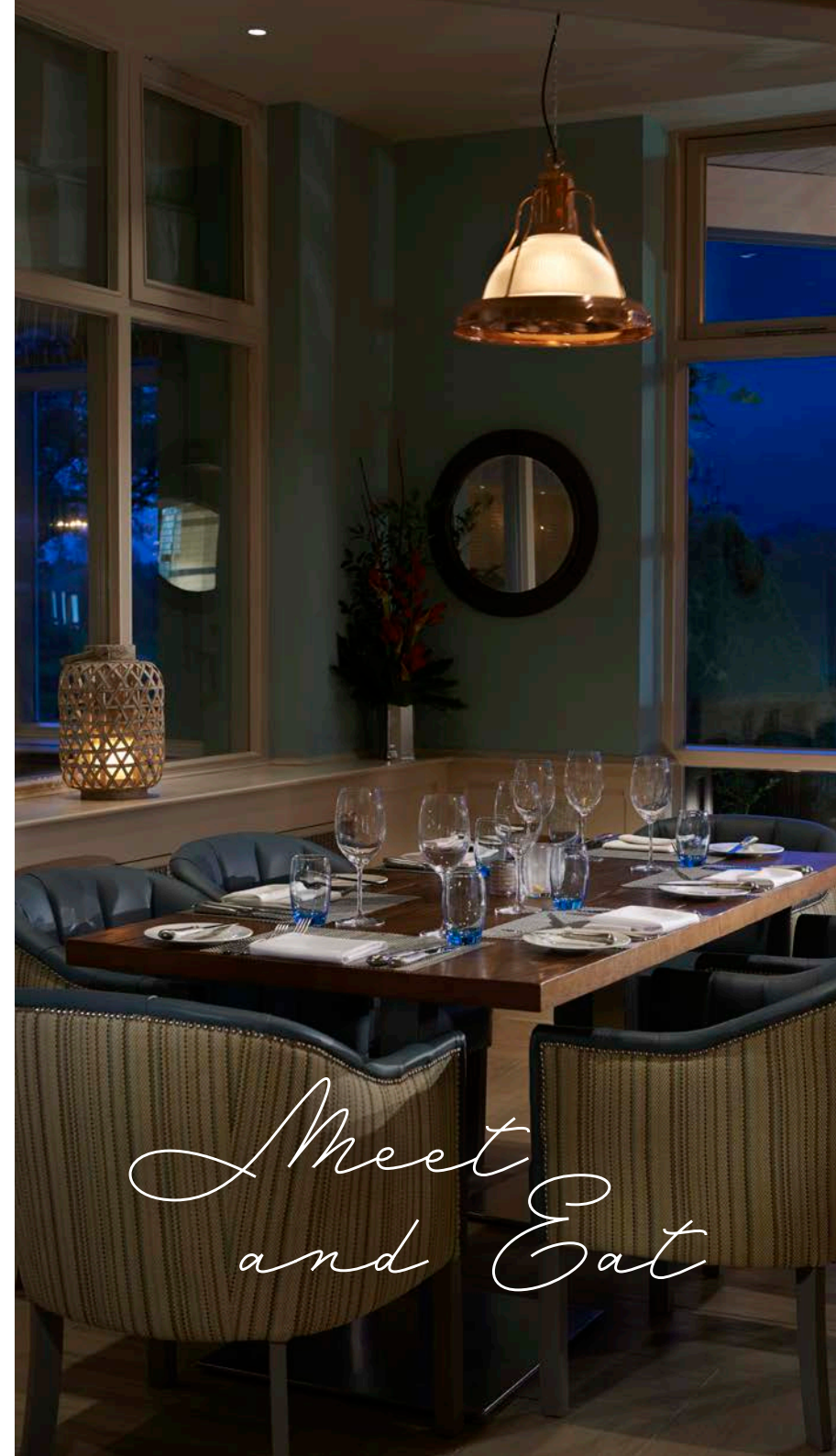



*Creating a
big Impression*

WHY THE BELFRY?

The Belfry experience is simply unforgettable. You'll find our team of experienced professionals as welcoming as they are passionate about creating an event perfectly tailored to your needs: just tell us what you want and let us make it happen. Both the team, and the hotel has a wealth of experience so whether you want a lavish presentation or a high profile event that requires discretion and sensitivity, The Belfry offers it all and delivers with high standards to match.

Easy To Reach

Located just minutes from the UK's major motorway and rail networks, less than 70 minutes train journey from London and easy transfer from Birmingham International Airport and Nottingham East Midlands Airport, however far your guests are travelling, our central location ensures ease and accessibility for all guests.

TO FIND OUT MORE
CALL 0844 980 0600
OR EMAIL SALES@THEBELFRY.COM



ROOM LAYOUTS

THE WOODLAND SUITE

Maximum Capacity 418

Theatre 418 | Classroom 214 | Banqueting 276

The self-contained Woodland Suite is ideal for private conferences and exhibition facilities but equally adaptable when a smaller space is required. With 48 Woodland Lodge bedrooms close by, plus its own bar and dining area, The Woodland Suite makes the ideal private conference facility, complete with its own dedicated registration and bar area. This is the perfect stand-alone venue for your delegates.

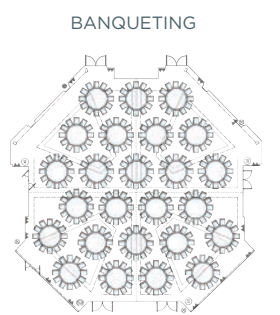
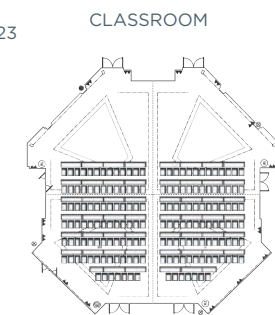
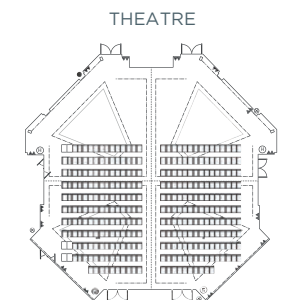
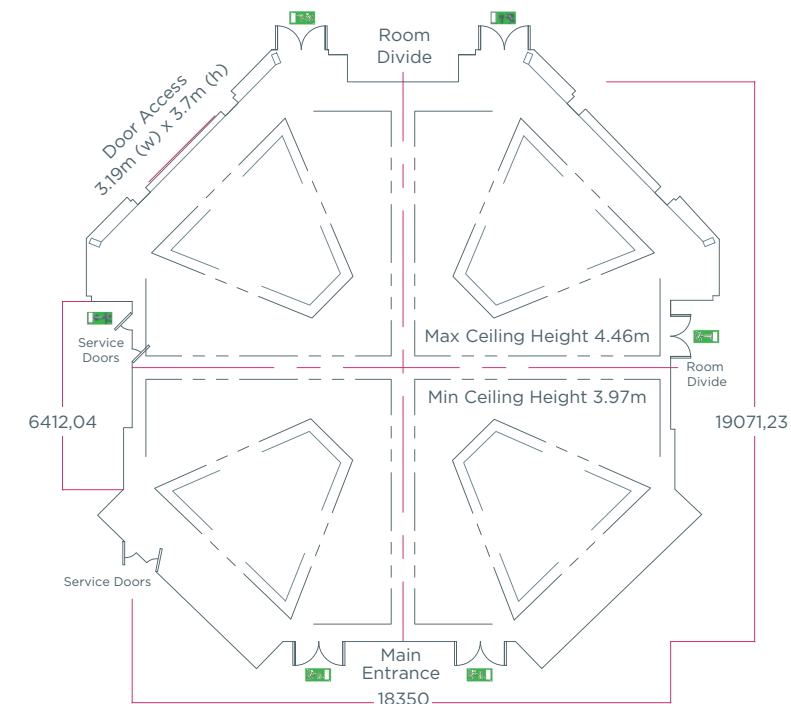

THE WARWICK SUITE

Maximum Capacity 276

Theatre 276 | Classroom 200 | Banqueting 253

As the second largest of our function rooms, The Warwick suite enjoys a ground floor location at the heart of the resort with a dedicated bar facility – an imposing space to truly impress.

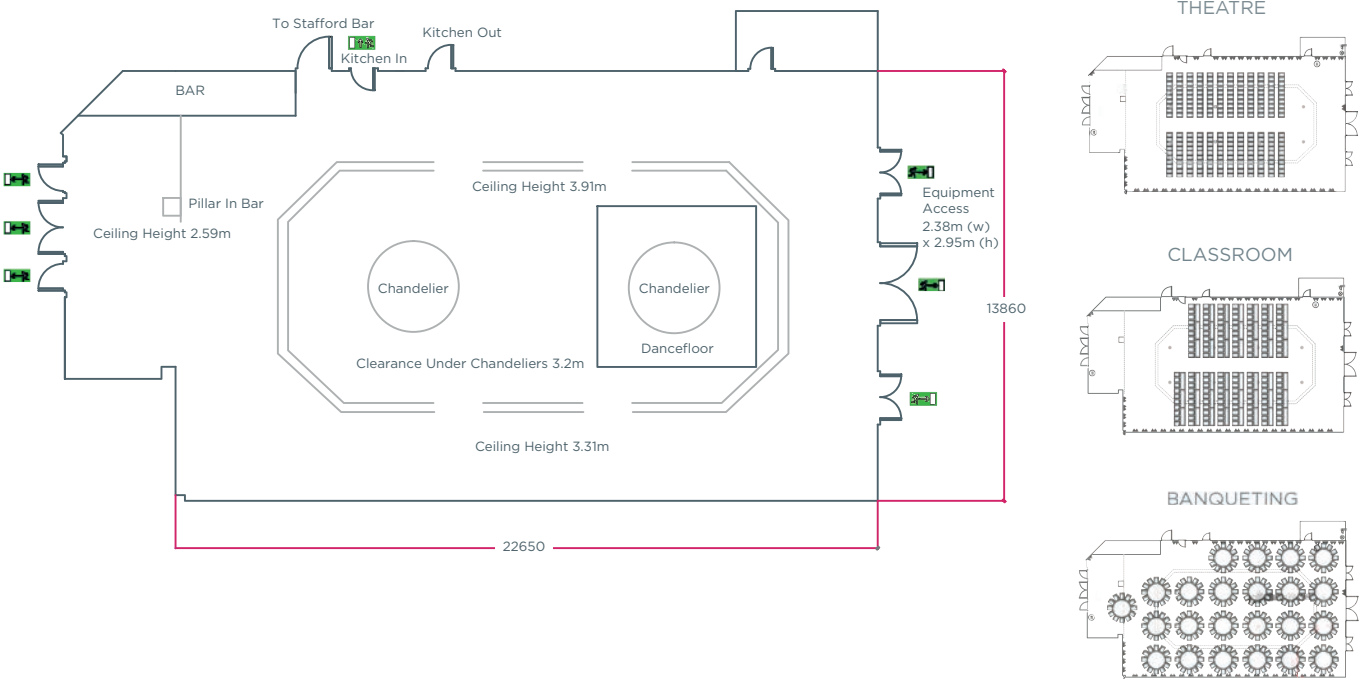

THE WISHAW SUITE

Maximum Capacity 184

Theatre 184 | Classroom 98 | Banqueting 132
Boardroom 38 | U Shape 42

Overlooking the famous 10th hole of The Brabazon course, the Wishaw Suite boasts a vista which will take your guests' breath away. What's more, with an airy, high ceiling, a private bar facility and easy goods access, it makes the ideal venue for a spectacular product launch or presentation.

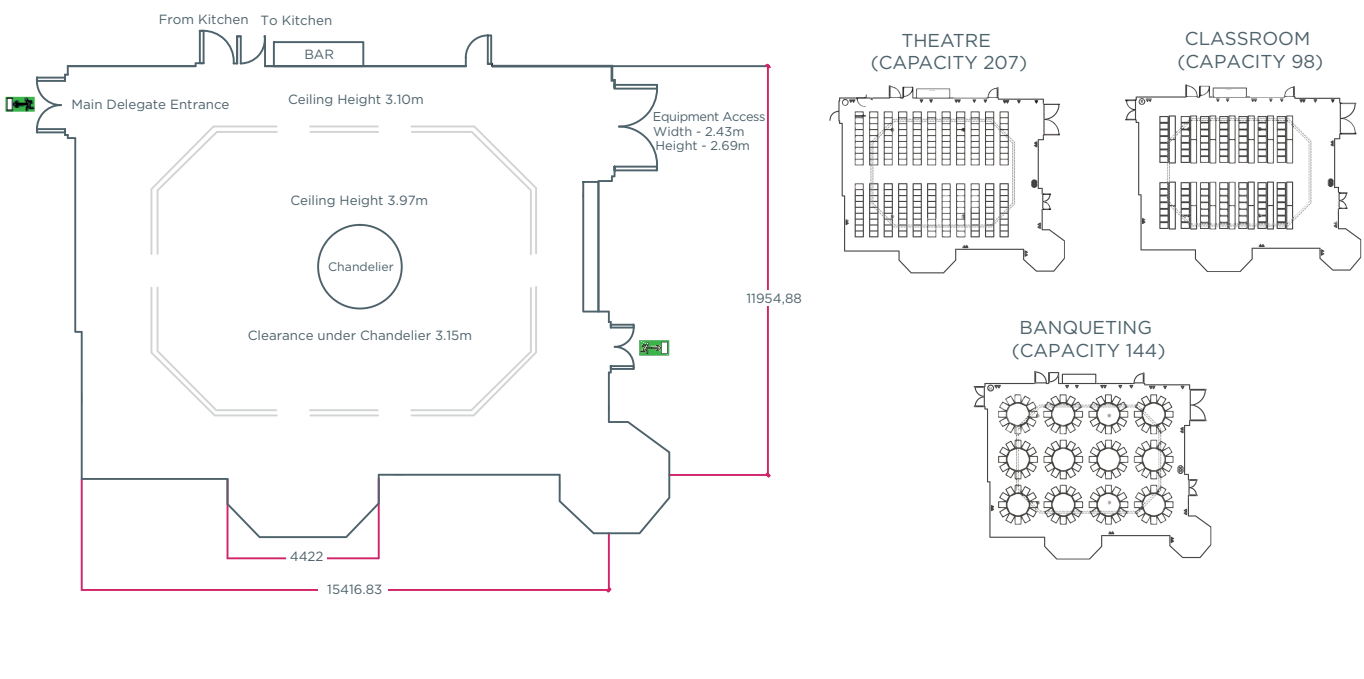

THE LICHFIELD SUITE

Maximum Capacity 150

Theatre 150 | Classroom 96 | Banqueting 144
Boardroom 40 | U Shape 44

Famed as the American team room during Ryder Cup Matches, the Lichfield Suite overlooks the stunning Lichfield lawn with its attractive and fragrant herb garden. This versatile room can be split into three syndicate break-out rooms and features its own lounge areas including adjoining room with dedicated bar. You can also make the most of the weather and extend your event onto the Lichfield lawn.

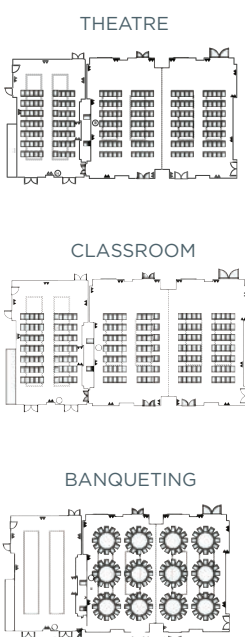
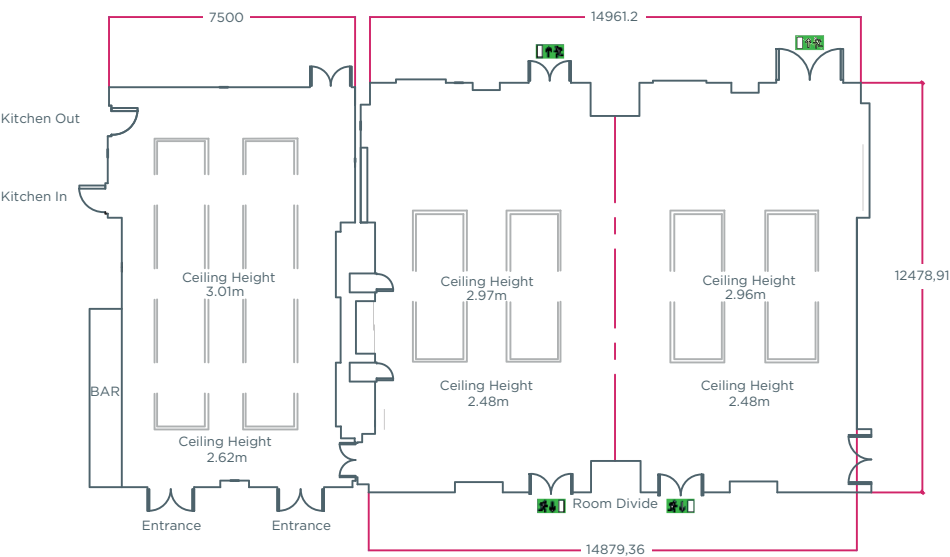

THE SUTTON SUITE

Maximum Capacity 100

Theatre 100 | Classroom 60 | Boardroom 36
Banqueting 96 | U Shape 40

The Sutton Suite leads onto an outdoor patio area with stunning views of The Brabazon course with its own bar facility and elegant wood-panelled walls.

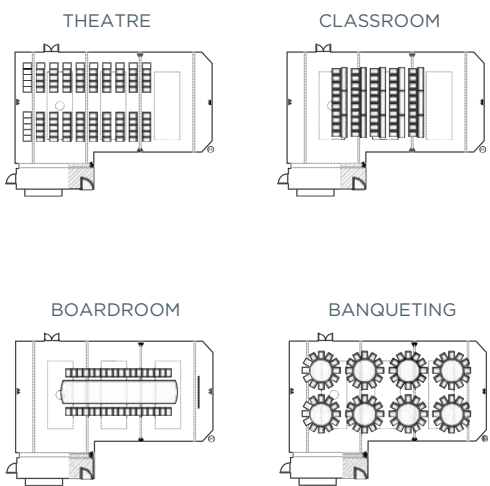
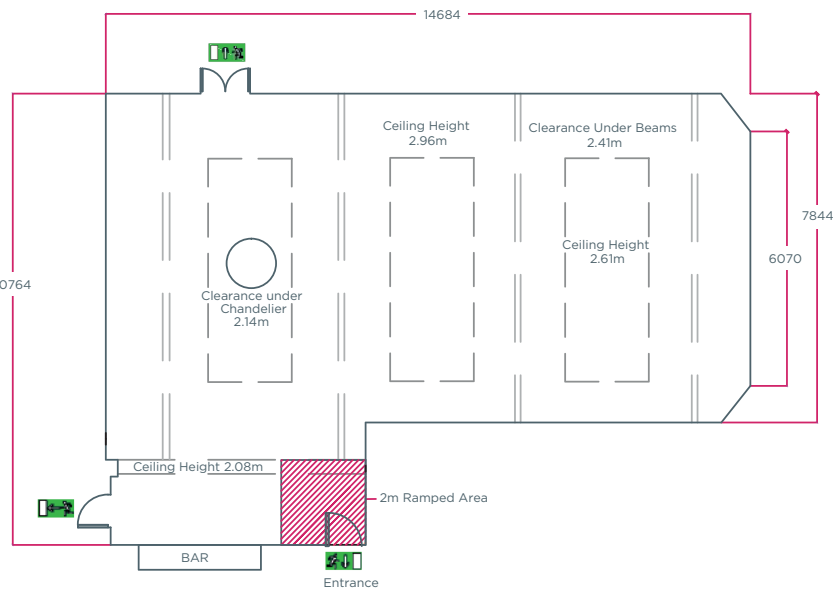

THE WORCESTER SUITE

Maximum Capacity 50

Theatre 50 | Classroom 36 | Boardroom 26
Banqueting 50 | U Shape 26

Traditionally the European team room in Ryder Cup Matches, the Worcester Suite has a dedicated bar area, ideal for break-out sessions or refreshments - plus a private patio area overlooking The Brabazon first tee for pre-dinner drinks or a quick break in the fresh air.

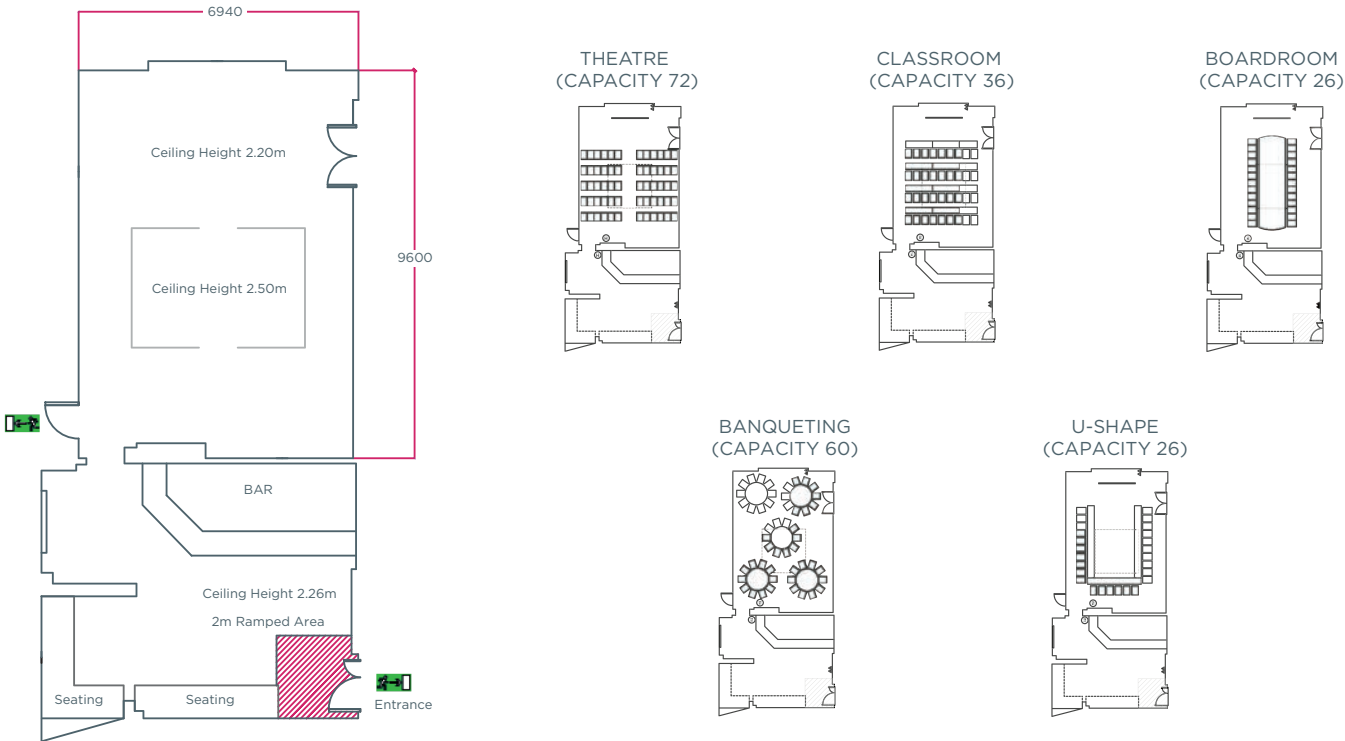

THE STAFFORD SUITE

Maximum Capacity 50

Theatre 50 | Classroom 35 | Boardroom 28
Banqueting 40 | U Shape 20

Located in a convenient central location, The Stafford Suite boasts floor to ceiling windows for a light, airy feel.

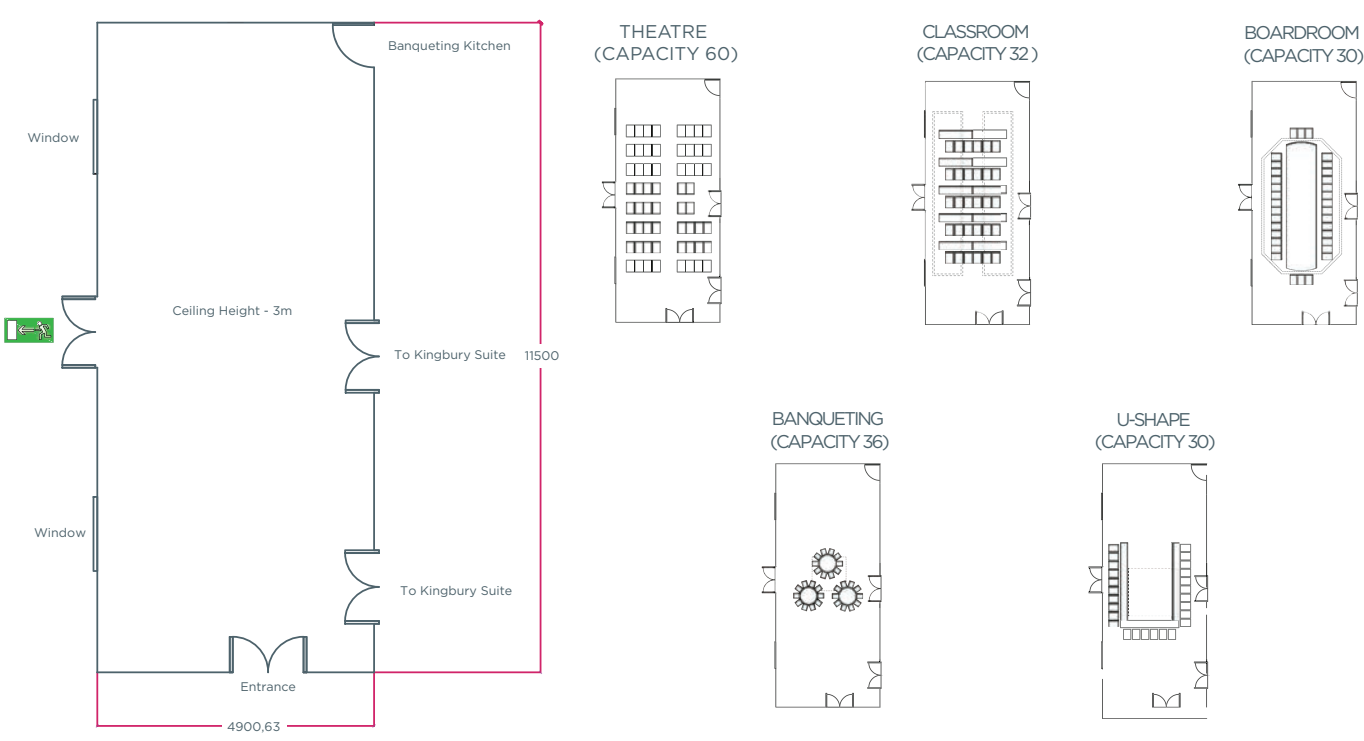

THE RYDER ROOM

Maximum Capacity 60

Theatre 60 | Classroom 30 | Boardroom 26
Banqueting 50 | U Shape 24

Home of the European team room in the 2001 Ryder Cup, this sensational room features historic photographs of the teams from the 1920s onwards, and breathtaking panoramic views across our world-famous golf courses. The Ryder Room also includes its own library-style seating and bar area.

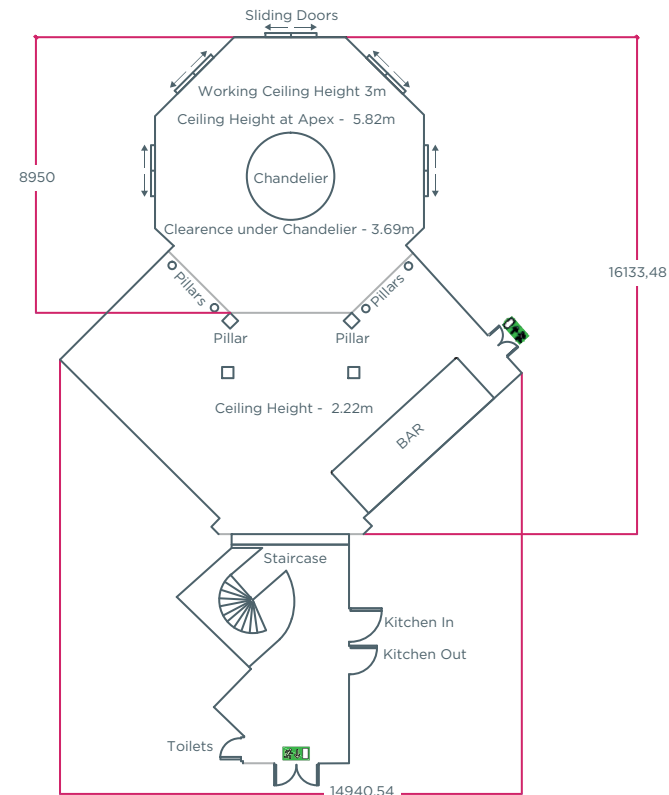

THE COTTON SUITE

Maximum Capacity 48

This second floor room offers spectacular views across the PGA National and The Brabazon courses and has a bright, airy ambience.

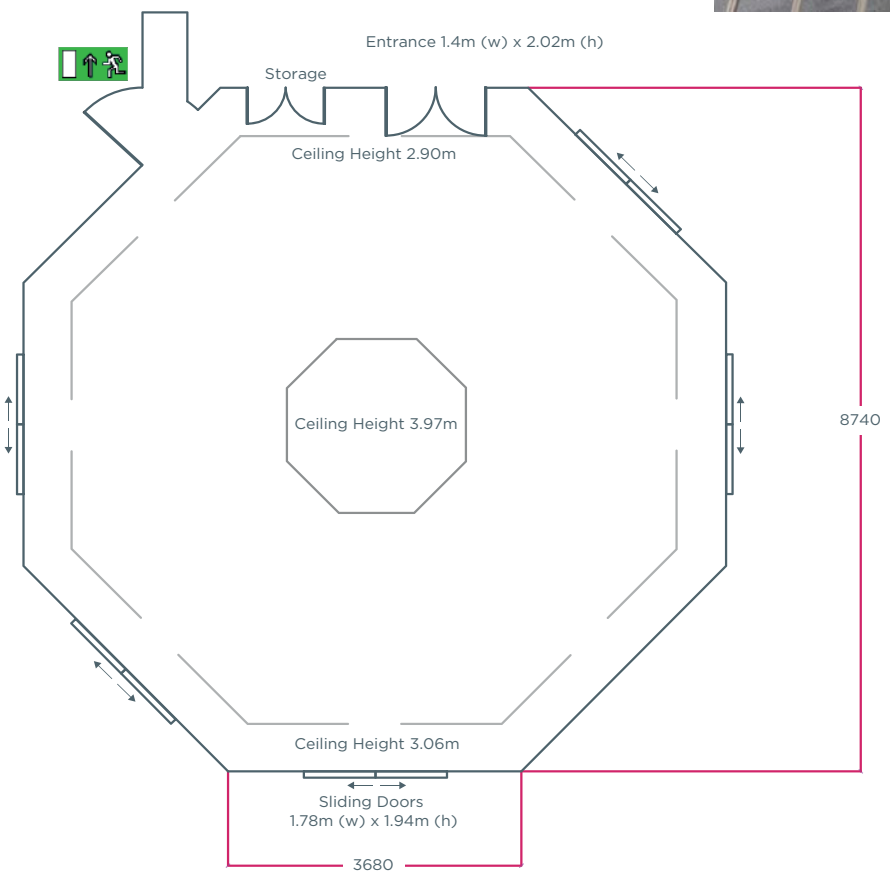

THE KINGSBURY SUITE

Maximum Capacity 30

Located in the centre of the hotel, the Kingsbury Suite is ideal for breakout sessions, syndicates and dining.

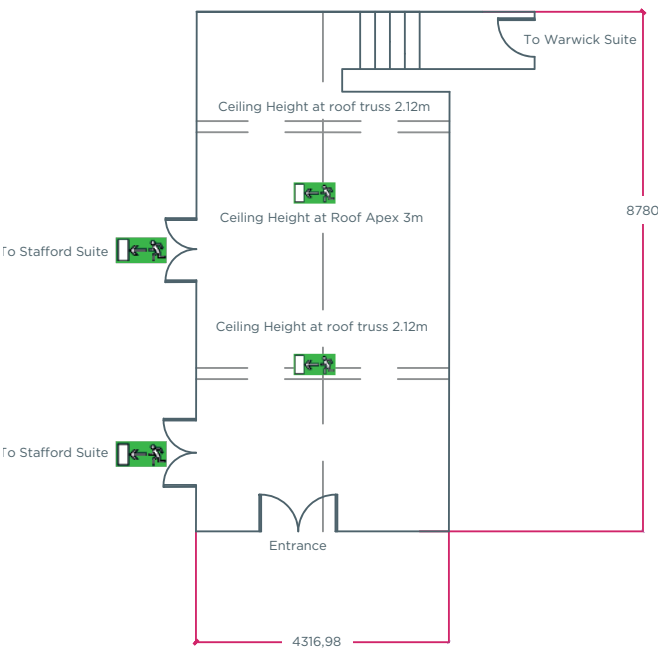

BOARDROOMS

Maximum Capacity 12

All six of our boardrooms offer everything you'll need for the perfect meeting, including flipchart, LCD data projector with screen and in-room drinks facilities, leaving you to concentrate on your meeting and guests.

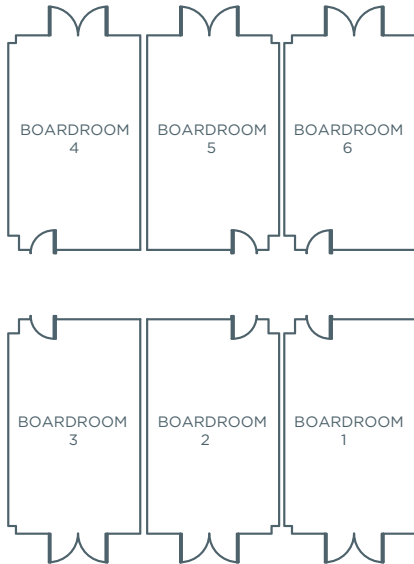
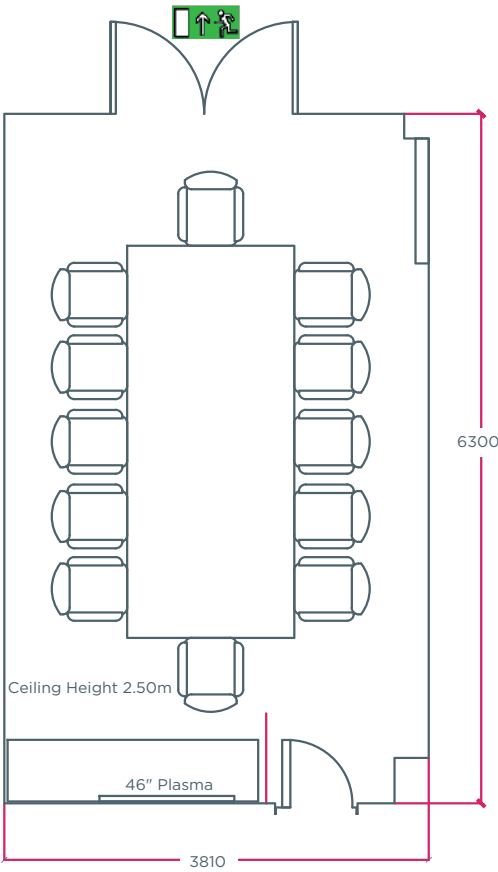

BEL AIR NIGHTCLUB & LOUNGE

Maximum Capacity 1,000

The Bel Air Nighthclub and Lounge is self-contained and situated in the hotel grounds. This diverse space has state of the art music and lighting systems, views of the 10th hole of The Brabazon, a private area for refreshments plus a dedicated entrance and car park for easy access.

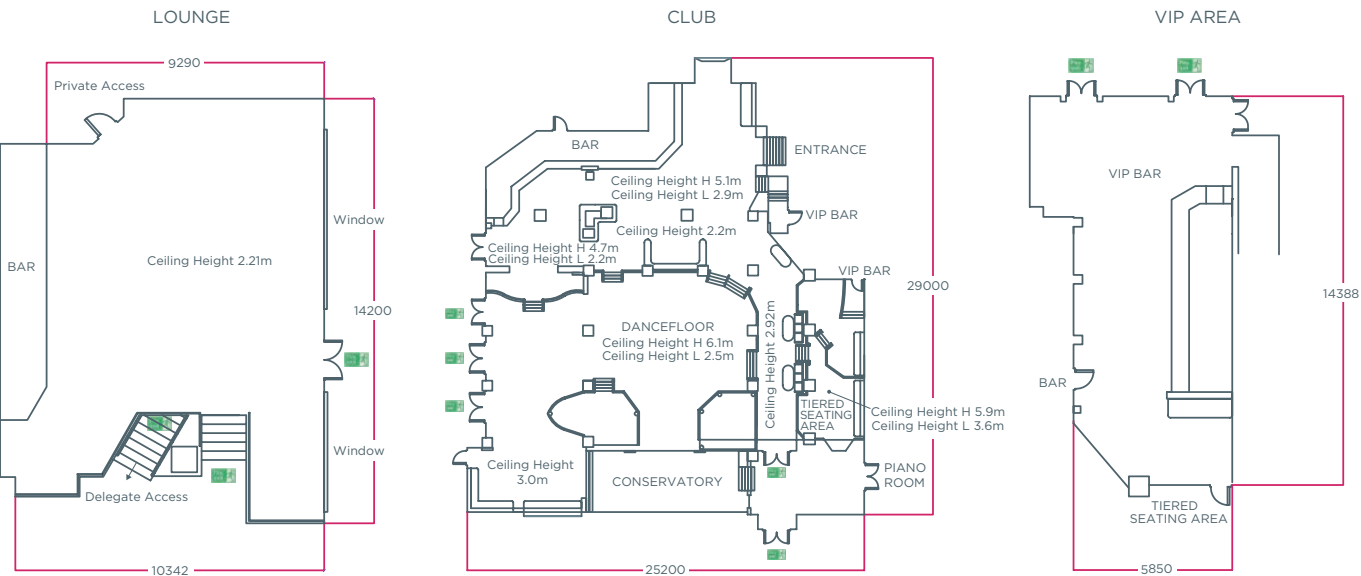

TOUCHDOWNS

Maximum Capacity 6

Situated just off the chic Brabazon Bar, the Touchdowns provide a perfect space for smaller meetings and informal gatherings. With glass fronted doors, you still feel part of the hotel whilst having the privacy of your own space.

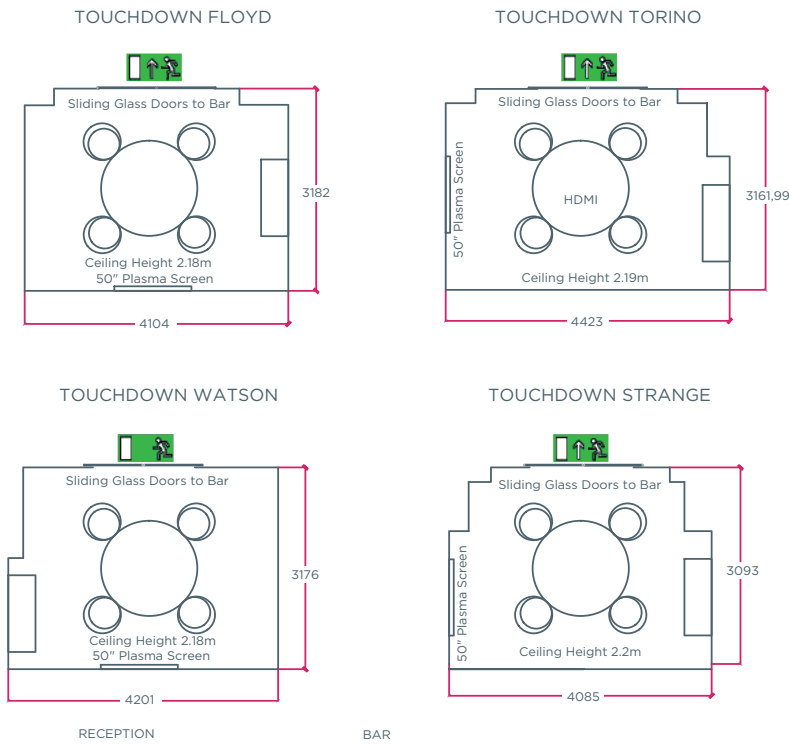

THE WINE ROOM PRIVATE DINING

Maximum Capacity 12

Give your meeting added prestige and dine in our esteemed Wine Room. Select your own menu and wine list for your guests to create the most personalised private dining experience.

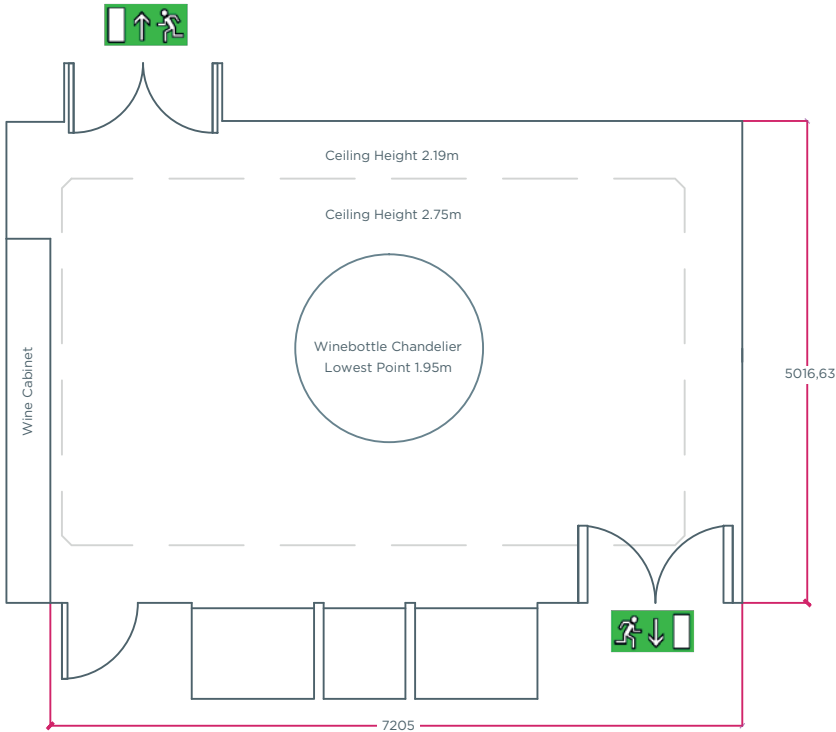

LAKE VIEW

Maximum Capacity 40

Located in the heart of the hotel, Lake View has stunning views over the putting green, the iconic 18th hole of the Brabazon and the lake. Opening onto the Manor House Terrace, Lake View is perfect for a drinks reception or private dinner.

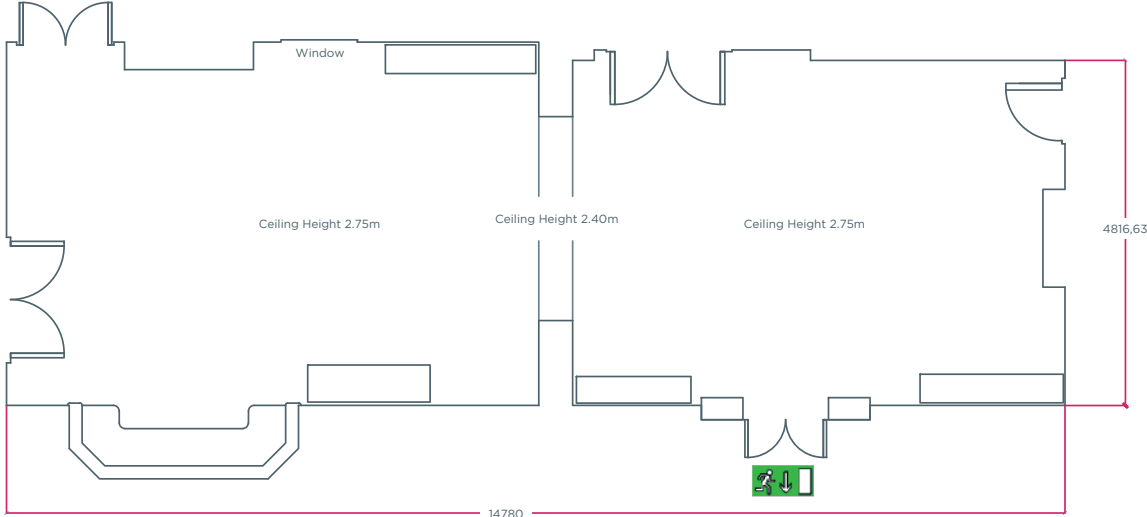



THE BELFRY

HOTEL & RESORT



The Belfry Hotel & Resort, Lichfield Road, Wishaw,
Sutton Coldfield, West Midlands, B76 9PR

www.TheBelfry.com [f](#) Belfryhotel [t](#) TheBelfryHotel [in](#) the-belfry-golf-resort